

FOR INFORMATION

Design shown is indicative and subject to ongoing studies and assessment during the design development process

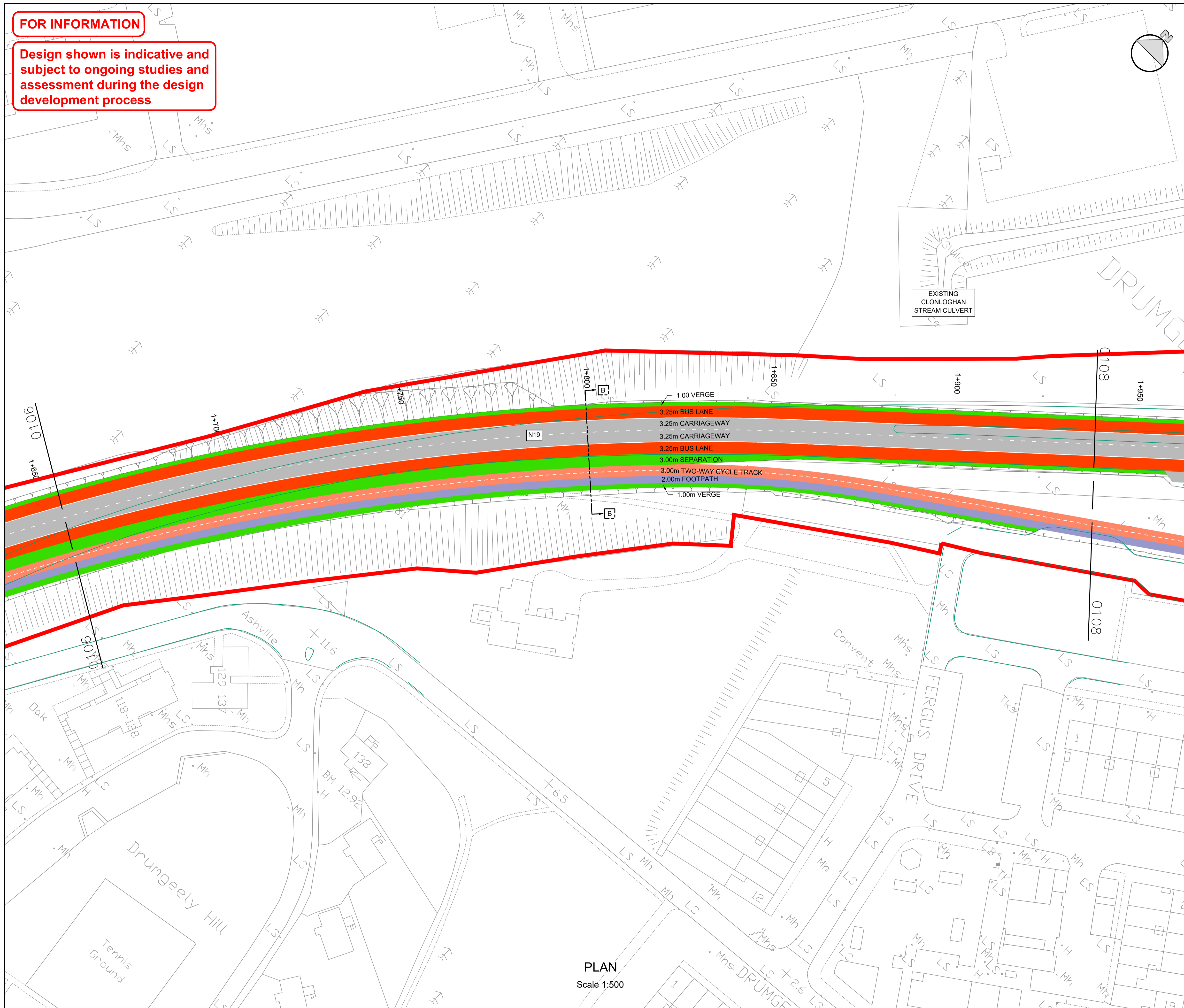

PLAN
Scale 1:500

NOTES

- This drawing is the property of Clandillon Civil Consulting. This drawing should not be relied on or used in circumstances other than those for which it was originally prepared and for which Clandillon Civil Consulting was commissioned.
- No part of this document may be reproduced or transmitted in any form or stored in any retrieval system of any nature without the written permission of CCC as copyright holder except as agreed for use on the project for which the document was originally issued. Do not scale. Use figured dimensions only. If in doubt - Ask!

LEGEND

- PLANNING APPLICATION BOUNDARY
- EXISTING EDGE OF ROAD
- PAVEMENT EXTENT
- BUS LANE
- SHARED SURFACE
- FOOTPATH
- EXISTING FOOTPATH
- GRASSED AREA
- CONTROLLED CROSSING AREA (PEDESTRIANS)
- 3.0m TWO WAY CYCLE TRACK
- 2.0m ONE WAY CYCLE TRACK
- CONTROLLED CROSSING AREA (CYCLISTS)
- TABLE RAMP CROSSING
- PAVED ISLAND/MEDIAN AREA IN ACCORDANCE WITH TII SCDs
- CONTROLLED CROSSING RED TACTILE PAVING
- UNCONTROLLED CROSSING BUFF TACTILE PAVING
- CORDUROY PAVING
- TRAFFIC SIGNAL POLE

KEYPLAN

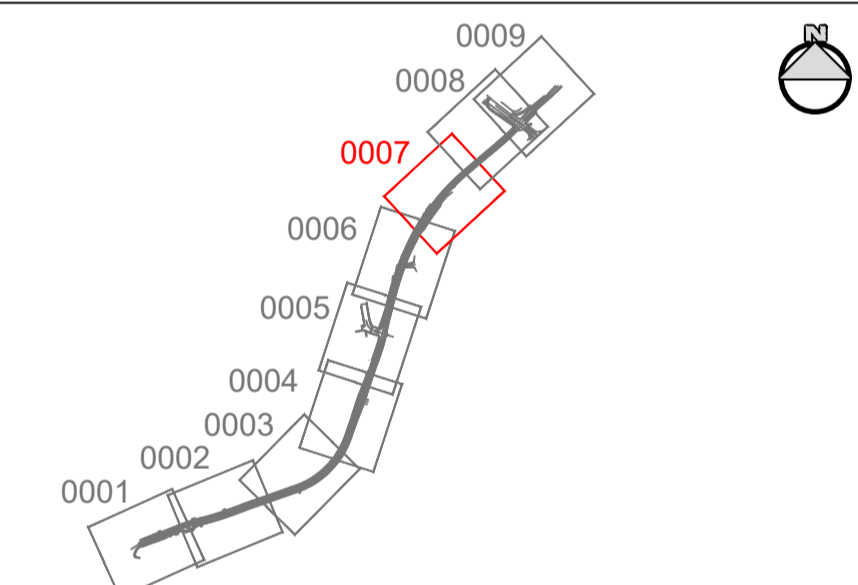

REV	DATE	DESCRIPTION	BY	CHK	APD
100	14/02/2023	DESIGN UPDATE MAR 2023	MV	TM	TM

PROJECT
N19 SHANNON AIRPORT
ACCESS ROAD IMPROVEMENT SCHEME

DRAWING TITLE
GENERAL ARRANGEMENT

SHEET 7 OF 9

DESIGNED	DRAWN	CHECKED/APPROVED
TM	MV	TM
DATE	SCALE	SHEET SIZE
14/02/2023	1:500	A1
DRAWING NUMBER	REVISION	
N19SAAR-FTC-GA-XX-DR-C-0107	100	