

PRELIMINARY OUTLINE
SUBJECT TO CHANGE DURING
SCHEME DEVELOPMENT

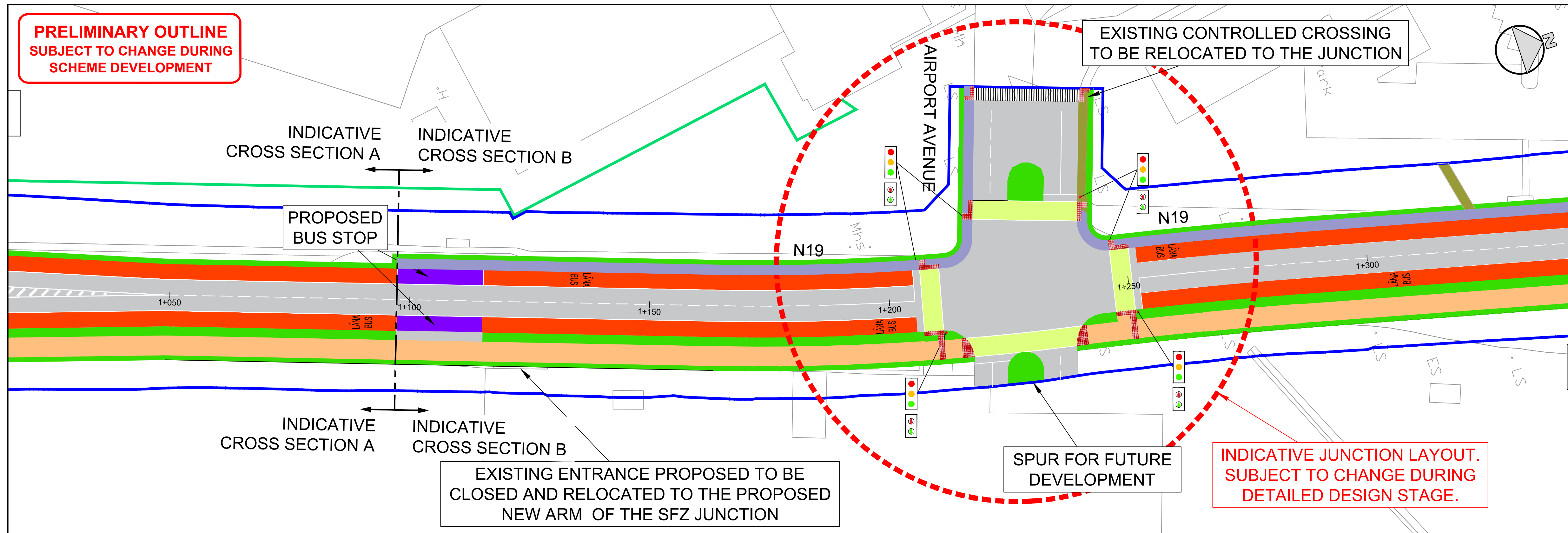

NOTES

1. This drawing is the property of Clare County Council. This drawing should not be relied on or used in circumstances other than those for which it was originally prepared and for which Clare County Council was commissioned.
2. No part of this document may be reproduced or transmitted in any form or stored in any retrieval system of any nature without the written permission of CCC as copyright holder except as agreed for use on the project for which the document was originally issued. Do not scale. Use figured dimensions only. If in doubt - Ask!

LEGEND

	Pavement Extent
	Verge/Grass Area
	Segregated Footpath/Cycleway
	Footpath
	Bus Stop
	Bus Lane
	Crossings
	Indicative Corridor Extents
	Existing Airport Security Fence
	Existing Footpath to be Retained
	ESB Sub-Station

Junctions and accesses are subject to change during Detailed Design Stage and in consultation with Key Stakeholders during Phase 3.

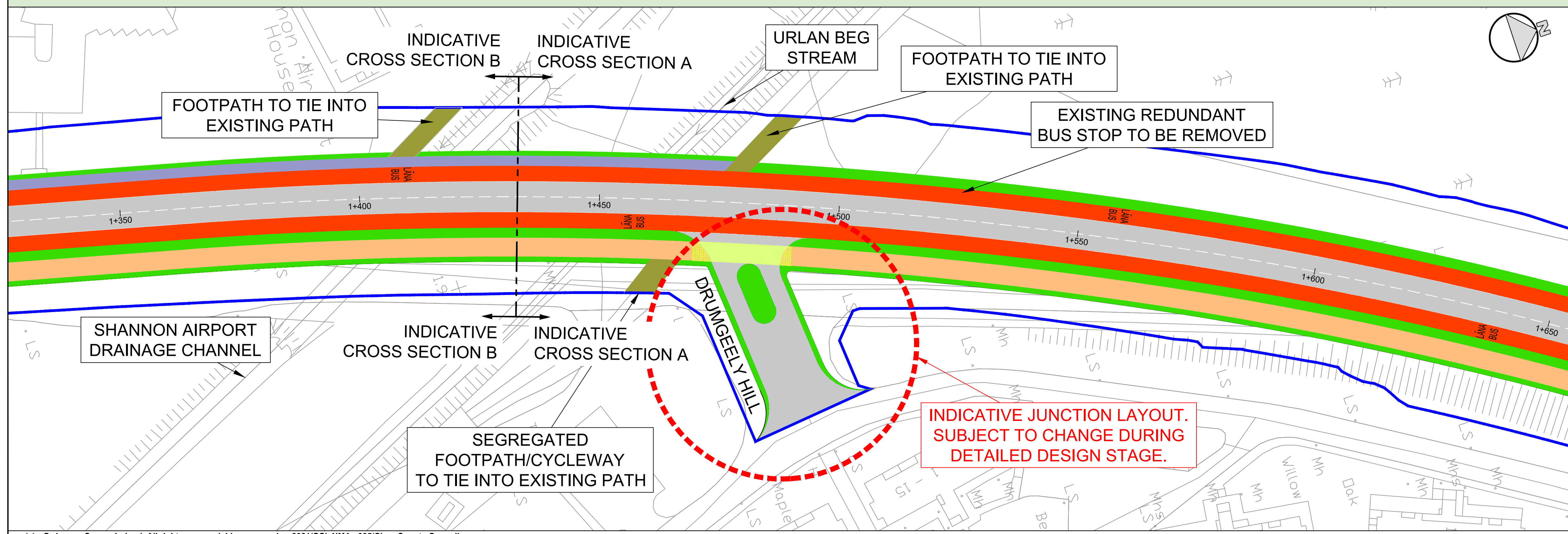
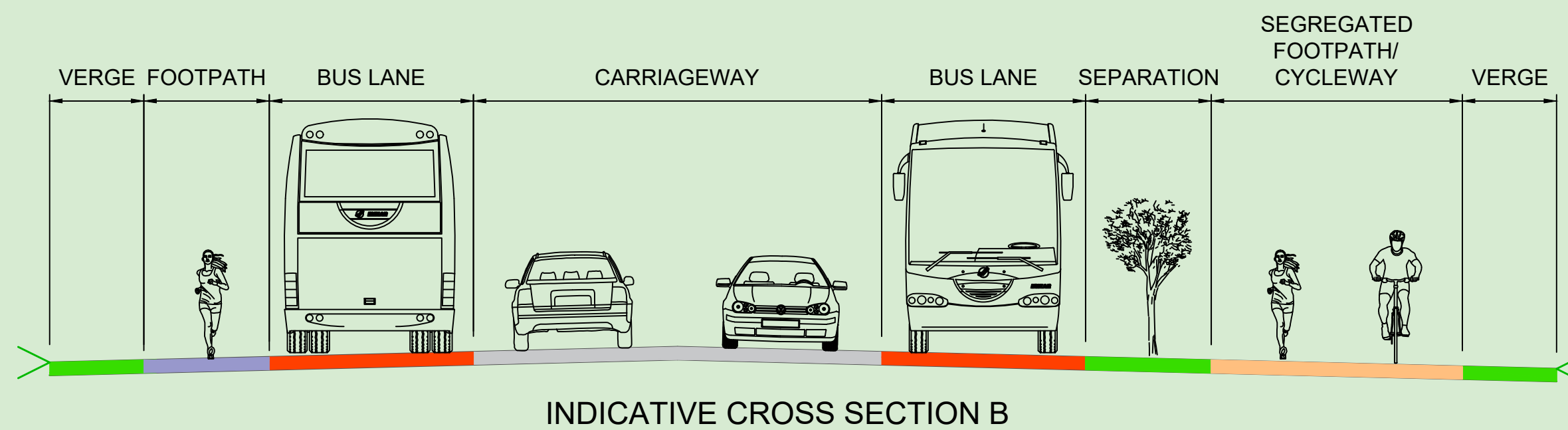
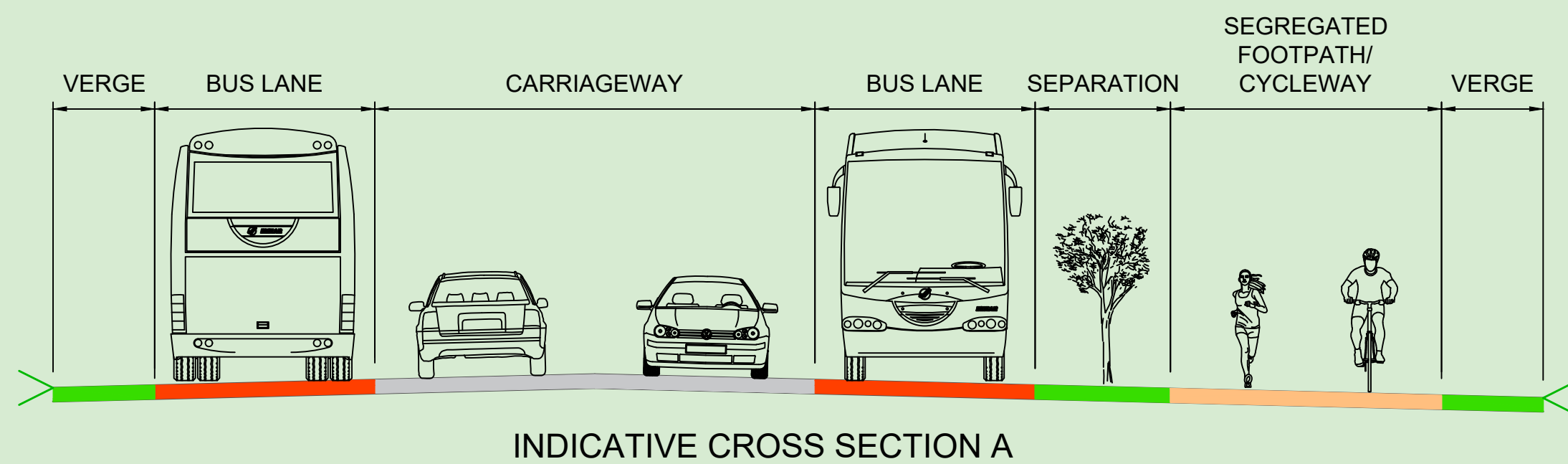

REV	DATE	DESCRIPTION	BY	CHK	APD
P01	09/11/2021	Preliminary Outline	ZM	DB	SC
P00	01/11/2021	Preliminary Outline	ZM	DB	SC

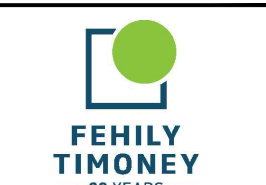

PROJECT
**N19 SHANNON AIRPORT
ACCESS ROAD IMPROVEMENT SCHEME**

DRAWING TITLE
**PUBLIC DISPLAY
PREFERRED OPTION
SHEET 3 OF 4**

DESIGNED RB	DRAWN ZM	CHECKED/APPROVED SC
DATE 01/11/2021	SCALE NTS	SHEET SIZE A1
DRAWING NUMBER N19-SAARS-DR-CW-04-0011	REVISION P01	