

**PRELIMINARY OUTLINE
SUBJECT TO CHANGE DURING
SCHEME DEVELOPMENT**

INDICATIVE
CROSS SECTION A

INDICATIVE
CROSS SECTION A

INDICATIVE
CROSS SECTION A

INDICATIVE
CROSS SECTION A

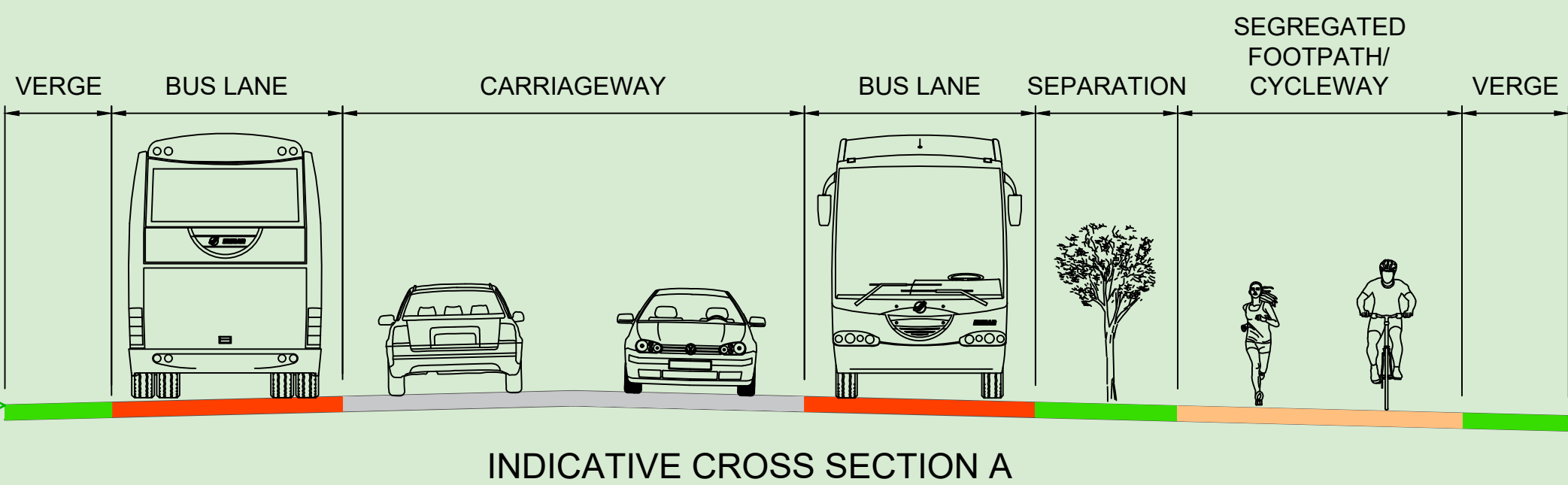

TIE-IN TO EXISTING
FOOTPATH

TIE-IN TO EXISTING
ROAD CROSS SECTION

TIE-IN TO EXISTING
ROAD CROSS SECTION

**INDICATIVE JUNCTION LAYOUT.
SUBJECT TO CHANGE DURING
DETAILED DESIGN STAGE.**

TIE-IN TO EXISTING
FOOTPATH

EXISTING OVERHEAD
PEDESTRIAN BRIDGE

NOTES

1. This drawing is the property of Clare County Council. This drawing should not be relied on or used in circumstances other than those for which it was originally prepared and for which Clare County Council was commissioned.
2. No part of this document may be reproduced or transmitted in any form or stored in any retrieval system of any nature without the written permission of CCC as copyright holder except as agreed for use on the project for which the document was originally issued. Do not scale. Use figured dimensions only. If in doubt - Ask!

LEGEND

- Pavement Extent
- Verge/Grass Area
- Segregated Footpath/Cycleway
- Footpath
- Bus Stop
- Bus Lane
- Crossings
- Indicative Corridor Extents
- Existing Airport Security Fence
- Existing Footpath to be Retained
- ESB Sub-Station

**Junctions and accesses are subject to
change during Detailed Design Stage
and in consultation with Key
Stakeholders during Phase 3.**

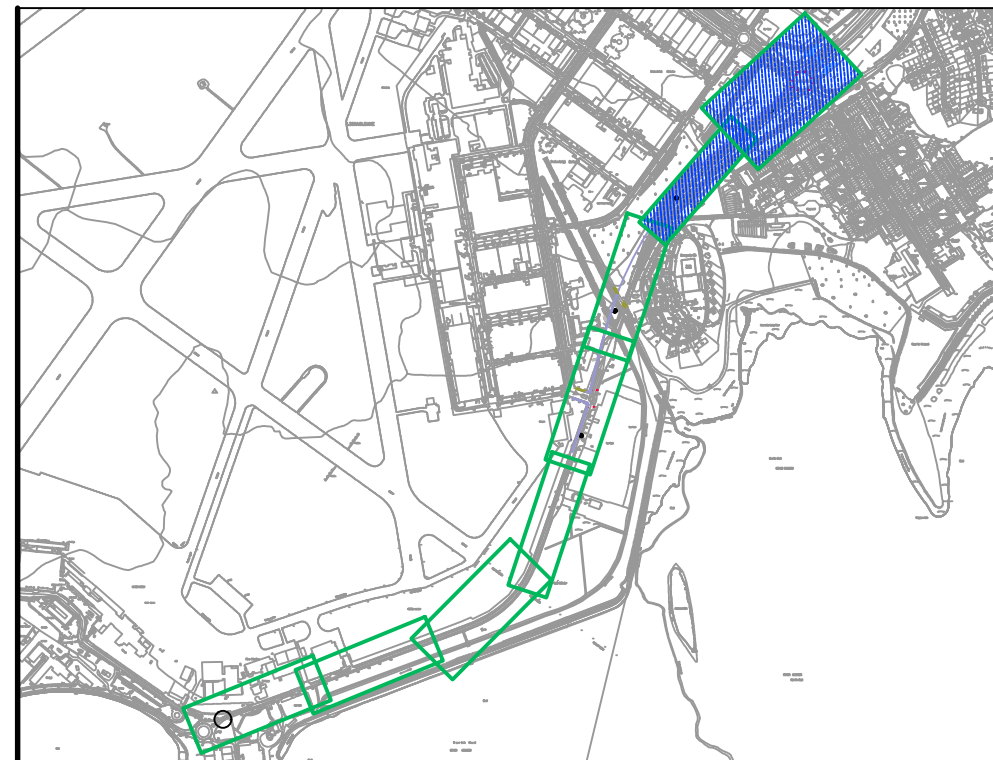

REV	DATE	DESCRIPTION	BY	CHK	APD
P01	09/11/2021	Preliminary Outline	ZM	DB	SC
P00	01/11/2021	Preliminary Outline	ZM	DB	SC



**Tionscadal Éireann
Project Ireland
2040**



An Roinn Iompair
Department of Transport



**N19 SHANNON AIRPORT
ACCESS ROAD IMPROVEMENT SCHEME**

**PUBLIC DISPLAY
PREFERRED OPTION
SHEET 4 OF 4**

DESIGNED RB	DRAWN ZM	CHECKED/APPROVED SC
DATE 01/11/2021	SCALE NTS	SHEET SIZE A1
DRAWING NUMBER N19-SAARS-DR-CW-04-0012	REVISION P01	